

### 3.4 Double-Tee Load Tables (cont.)

#### Strand Pattern Designation

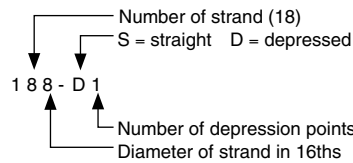

Safe loads shown include dead load of 10 lb/ft<sup>2</sup> for untopped members and 15 lb/ft<sup>2</sup> for topped members. Remainder is live load. Long-time cambers include superimposed dead load but do not include live load.

#### Key

- 186 – Safe superimposed service load, lb/ft<sup>2</sup>
- 2.0 – Estimated camber at erection, in.
- 2.4 – Estimated long-time camber, in.

#### 8'-0" in. x 32" Lightweight Concrete

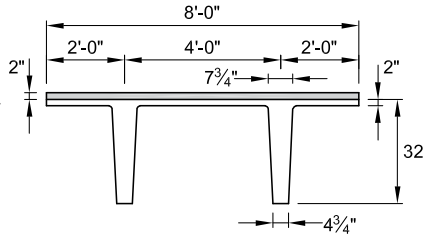

$$f'_c = 5000 \text{ psi}$$

$$f_{pu} = 270,000 \text{ psi}$$

1/2-in.-diameter regular strand

Check with regional producers for availability.

#### Section Properties

	No Topping	2 in. Topping
A	= 567 in. <sup>2</sup>	–
I	= 55,464 in. <sup>4</sup>	77,675 in. <sup>4</sup>
y <sub>b</sub>	= 21.21 in.	24.52 in.
y <sub>t</sub>	= 10.79 in.	9.48 in.
S <sub>b</sub>	= 2615 in. <sup>3</sup>	3167 in. <sup>3</sup>
S <sub>t</sub>	= 5140 in. <sup>3</sup>	8195 in. <sup>3</sup>
wt	= 453 lb/ft	653 lb/ft
DL	= 57 lb/ft <sup>2</sup>	82 lb/ft <sup>2</sup>
V/S	= 1.79 in.	

**8LDT32**

Table of safe superimposed service load, lb/ft<sup>2</sup>, and cambers, in.

No Topping

Strand pattern	y <sub>s</sub> (end) y <sub>s</sub> (center) in.	Span, ft																												
		50	52	54	56	58	60	62	64	66	68	70	72	74	76	78	80	82	84	86	88	90	92	94	96	98	100	102	104	
128-S	7.00	186	169	154	140	128	117	107	98	90	82	75	69	63	58	53	48	44	40	36	31	28								
	7.00	2.0	2.1	2.2	2.3	2.3	2.4	2.4	2.4	2.3	2.3	2.2	2.1	2.0	1.9	1.7	1.5	1.2	0.9	0.6	0.2									
148-S	8.00	193	176	161	147	134	123	113	104	95	87	80	74	68	62	57	52	47	43	38	34	30	26							
	8.00	2.3	2.4	2.5	2.6	2.6	2.7	2.7	2.8	2.8	2.7	2.7	2.7	2.6	2.5	2.3	2.1	1.9	1.7	1.4	1.0	0.6	0.2							
168-S	9.00		192	175	159	145	132	120	111	102	94	86	79	73	67	62	57	52	48	44	39	35	31	28						
	9.00		2.6	2.7	2.8	2.9	3.0	3.0	3.0	3.1	3.1	3.0	2.9	2.8	2.7	2.6	2.4	2.2	1.9	1.6	1.2	0.8	0.4							
188-S	10.00			185	168	154	140	128	117	107	99	91	84	77	71	65	60	55	51	47	43	39	35	31	28					
	10.00			2.8	2.9	3.0	3.1	3.1	3.2	3.2	3.2	3.2	3.2	3.2	3.1	3.0	2.8	2.7	2.5	2.2	1.9	1.6	1.2	0.9	0.8					
188-D1	14.39							172	158	146	134	124	114	105	97	90	83	76	70	64	59	54	49	46	43	40	37	34		
	4.00							4.1	4.3	4.4	4.5	4.6	4.7	4.8	4.8	4.8	4.8	4.7	4.6	4.4	4.2	4.0	3.7	3.4	3.0	2.7	2.2	1.7		
208-D1	15.50								5.0	5.1	5.2	5.2	5.2	5.2	5.1	5.0	4.8	4.5	4.2	3.8	3.4	2.8	2.2	1.5	0.9	0.2	-0.6	-1.4	-2.3	
	4.25															117	108	100	92	85	79	73	67	62	57	52	48	43	40	37
																5.2	5.2	5.3	5.3	5.3	5.3	5.2	5.1	4.9	4.7	4.4	4.0	3.7	3.3	2.8
																5.7	5.7	5.5	5.3	5.1	4.8	4.5	4.0	3.5	2.9	2.2	1.4	0.5	-0.3	-1.2

**8LDT32 + 2**

Table of safe superimposed service load, lb/ft<sup>2</sup>, and cambers, in.

2 in. Normalweight Topping

Strand pattern	y <sub>s</sub> (end) y <sub>s</sub> (center) in.	Span, ft																																																																																																																																																																																																																																																																																																																																																																																																																																																																																																																																																																																																																																																																																																																																								
		50	52	54	56	58	60	62	64	66	68	70	72	74	76	78	80	82	84	86	88	90	92	94	96	98																																																																																																																																																																																																																																																																																																																																																																																																																																																																																																																																																																																																																																																																																																																
128-S	7.00	183	165	149	134	121	109	99	89	81	73	64	56	49	42	35	29																																																																																																																																																																																																																																																																																																																																																																																																																																																																																																																																																																																																																																																																																																																									
	7.00	2.0	2.1	2.1	2.2	2.3	2.3	2.3	2.4	2.4	2.3	2.3	2.2	2.2	2.0	1.9	1.7	1.8	1.8	1.7	1.7	1.6	1.5	1.3	1.1	0.9	0.6	0.3	-0.1	-0.6	-1.1	-1.7	-2.4																																																																																																																																																																																																																																																																																																																																																																																																																																																																																																																																																																																																																																																																																																									
148-S	8.00		190	172	156	141	128	115	103	92	82	73	65	57	50	44	38	32	26																																																																																																																																																																																																																																																																																																																																																																																																																																																																																																																																																																																																																																																																																																																							
	8.00		2.3	2.4	2.5	2.6	2.6	2.7	2.7	2.8	2.8	2.8	2.7	2.7	2.6	2.5	2.3	2.1	1.9	2.1	2.1	2.0	2.0	1.9	1.7	1.6	1.5	1.4	1.3	1.2	1.1	1.0	0.9	0.8	0.7	0.6	0.5	0.4	0.3	0.2	0.1	0.0	-0.1	-0.2	-0.3	-0.4	-0.5	-0.6	-0.7	-0.8	-0.9	-1.0	-1.1	-1.2	-1.3	-1.4	-1.5	-1.6	-1.7	-1.8	-1.9	-2.0	-2.1	-2.2	-2.3	-2.4	-2.5	-2.6	-2.7	-2.8	-2.9	-3.0	-3.1	-3.2	-3.3	-3.4	-3.5	-3.6	-3.7	-3.8	-3.9	-4.0	-4.1	-4.2	-4.3	-4.4	-4.5	-4.6	-4.7	-4.8	-4.9	-5.0	-5.1	-5.2	-5.3	-5.4	-5.5	-5.6	-5.7	-5.8	-5.9	-6.0	-6.1	-6.2	-6.3	-6.4	-6.5	-6.6	-6.7	-6.8	-6.9	-7.0	-7.1	-7.2	-7.3	-7.4	-7.5	-7.6	-7.7	-7.8	-7.9	-8.0	-8.1	-8.2	-8.3	-8.4	-8.5	-8.6	-8.7	-8.8	-8.9	-9.0	-9.1	-9.2	-9.3	-9.4	-9.5	-9.6	-9.7	-9.8	-9.9	-10.0	-10.1	-10.2	-10.3	-10.4	-10.5	-10.6	-10.7	-10.8	-10.9	-11.0	-11.1	-11.2	-11.3	-11.4	-11.5	-11.6	-11.7	-11.8	-11.9	-12.0	-12.1	-12.2	-12.3	-12.4	-12.5	-12.6	-12.7	-12.8	-12.9	-13.0	-13.1	-13.2	-13.3	-13.4	-13.5	-13.6	-13.7	-13.8	-13.9	-14.0	-14.1	-14.2	-14.3	-14.4	-14.5	-14.6	-14.7	-14.8	-14.9	-15.0	-15.1	-15.2	-15.3	-15.4	-15.5	-15.6	-15.7	-15.8	-15.9	-16.0	-16.1	-16.2	-16.3	-16.4	-16.5	-16.6	-16.7	-16.8	-16.9	-17.0	-17.1	-17.2	-17.3	-17.4	-17.5	-17.6	-17.7	-17.8	-17.9	-18.0	-18.1	-18.2	-18.3	-18.4	-18.5	-18.6	-18.7	-18.8	-18.9	-19.0	-19.1	-19.2	-19.3	-19.4	-19.5	-19.6	-19.7	-19.8	-19.9	-20.0	-20.1	-20.2	-20.3	-20.4	-20.5	-20.6	-20.7	-20.8	-20.9	-21.0	-21.1	-21.2	-21.3	-21.4	-21.5	-21.6	-21.7	-21.8	-21.9	-22.0	-22.1	-22.2	-22.3	-22.4	-22.5	-22.6	-22.7	-22.8	-22.9	-23.0	-23.1	-23.2	-23.3	-23.4	-23.5	-23.6	-23.7	-23.8	-23.9	-24.0	-24.1	-24.2	-24.3	-24.4	-24.5	-24.6	-24.7	-24.8	-24.9	-25.0	-25.1	-25.2	-25.3	-25.4	-25.5	-25.6	-25.7	-25.8	-25.9	-26.0	-26.1	-26.2	-26.3	-26.4	-26.5	-26.6	-26.7	-26.8	-26.9	-27.0	-27.1	-27.2	-27.3	-27.4	-27.5	-27.6	-27.7	-27.8	-27.9	-28.0	-28.1	-28.2	-28.3	-28.4	-28.5	-28.6	-28.7	-28.8	-28.9	-29.0	-29.1	-29.2	-29.3	-29.4	-29.5	-29.6	-29.7	-29.8	-29.9	-30.0	-30.1	-30.2	-30.3	-30.4	-30.5	-30.6	-30.7	-30.8	-30.9	-31.0	-31.1	-31.2	-31.3	-31.4	-31.5	-31.6	-31.7	-31.8	-31.9	-32.0	-32.1	-32.2	-32.3	-32.4	-32.5	-32.6	-32.7	-32.8	-32.9	-33.0	-33.1	-33.2	-33.3	-33.4	-33.5	-33.6	-33.7	-33.8	-33.9	-34.0	-34.1	-34.2	-34.3	-34.4	-34.5	-34.6	-34.7	-34.8	-34.9	-35.0	-35.1	-35.2	-35.3	-35.4	-35.5	-35.6	-35.7	-35.8	-35.9	-36.0	-36.1	-36.2	-36.3	-36.4	-36.5	-36.6	-36.7	-36.8	-36.9	-37.0	-37.1	-37.2	-37.3	-37.4	-37.5	-37.6	-37.7	-37.8	-37.9	-38.0	-38.1	-38.2	-38.3	-38.4	-38.5	-38.6	-38.7	-38.8	-38.9	-39.0	-39.1	-39.2	-39.3	-39.4	-39.5	-39.6	-39.7	-39.8	-39.9	-40.0	-40.1	-40.2	-40.3	-40.4	-40.5	-40.6	-40.7	-40.8	-40.9	-41.0	-41.1	-41.2	-41.3	-41.4	-41.5	-41.6	-41.7	-41.8	-41.9	-42.0	-42.1	-42.2	-42.3	-42.4	-42.5	-42.6	-42.7	-42.8	-42.9	-43.0	-43.1	-43.2	-43.3	-43.4	-43.5	-43.6	-43.7	-43.8	-43.9	-44.0	-44.1	-44.2	-44.3	-44.4	-44.5	-44.6	-44.7	-44.8	-44.9	-45.0	-45.1	-45.2	-45.3	-45.4	-45.5	-45.6	-45.7	-45.8	-45.9	-46.0	-46.1	-46.2	-46.3	-46.4	-46.5	-46.6	-46.7	-46.8	-46.9	-47.0	-47.1	-47.2	-47.3	-47.4	-47.5	-47.6	-47.7	-47.8	-47.9	-48.0	-48.1	-48.2	-48.3	-48.4	-48.5	-48.6	-48.7	-48.8	-48.9	-49.0	-49.1	-49.2	-49.3	-49.4	-49.5	-49.6	-49.7	-49.8	-49.9	-50.0	-50.1	-50.2	-50.3	-50.4	-50.5	-50.6	-50.7	-50.8	-50.9	-51.0	-51.1	-51.2	-51.3	-51.4	-51.5	-51.6	-51.7	-51.8	-51.9	-52.0	-52.1	-52.2	-52.3	-52.4	-52.5	-52.6	-52.7	-52.8	-52.9	-53.0	-53.1	-53.2	-53.3	-53.4	-53.5	-53.6	-53.7	-53.8	-53.9	-54.0	-54.1	-54.2	-54.3	-54.4	-54.5	-54.6	-54.7	-54.8	-54.9	-55.0	-55.1	-55.2	-55.3	-55.4	-55.5	-55.6	-55.7	-55.8	-55.9	-56.0	-56.1	-56.2	-56.3	-56.4	-56.5	-56.6	-56.7	-56.8	-56.9	-57.0	-57.1	-57.2	-57.3	-57.4	-57.5	-57.6	-57.7	-57.8	-57.9	-58.0	-58.1	-58.2	-58.3	-58.4	-58.5	-58.6	-58.7	-58.8	-58.9	-59.0	-59.1	-59.2	-59.3	-59.4	-59.5	-59.6	-59.7	-59.8	-59.9	-60.0	-60.1	-60.2	-60.3	-60.4	-60.5	-60.6	-60.7	-60.8	-60.9	-61.0	-61.1	-61.2	-61.3	-61.4	-61.5	-61.6	-61.7	-61.8	-61.9	-62.0	-62.1	-62.2	-62.3	-62.4	-62.5	-62.6	-62.7	-62.8	-62.9	-63.0	-63.1	-63.2	-63.3	-63.4	-63.5	-63.6	-63.7	-63.8	-63.9	-64.0	-64.1	-64.2	-64.3	-64.4	-64.5	-64.6	-64.7	-64.8	-64.9	-65.0	-65.1	-65.2	-65.3	-65.4	-65.5	-65.6	-65.7	-65.8	-65.9	-66.0	-66.1	-66.2	-66.3	-66.4	-66.5	-66.6	-66.7	-66.8	-66.9	-67.0	-67.1	-67.2